



Yuasa Ficha Técnica

Yuasa B49-6 - Convencional 6 Volt Batería

Rendimiento

| | |
|----------------------|-------|
| Tensión | 6 |
| Capacidad (10-hour) | 8Ah |
| Capacidad (20 horas) | 8.4Ah |

Dimensiones (±2mm)

| | |
|-------|-------|
| Largo | 91mm |
| Ancho | 83mm |
| Alto | 161mm |

Peso

| | |
|------------------|-------|
| Peso con Acido | 2.1kg |
| Volumen de acido | 0.5l |

Tecnología

| | |
|-------------|-------------------------------|
| Tecnología | Placa Sb/Sb |
| Separadores | Reinforcing fiber+Glass Fiber |



Esquema



Tipo de terminal - 6

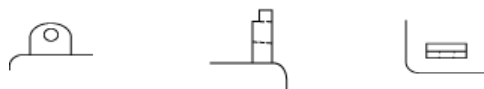

Fecha de emisión: 17/05/2024 - E&EO



Yuasa Technical Data Sheet

Yuasa B49-6 - Conventional 6 Volt Battery

Performance

| | |
|--------------------|-------|
| Voltage | 6 |
| Capacity (10-hour) | 8Ah |
| Capacity (20-hour) | 8.4Ah |

Dimensions ($\pm 2\text{mm}$)

| | |
|--------|-------|
| Length | 91mm |
| Width | 83mm |
| Height | 161mm |

Weights & Measures

| | |
|-----------------------|-------|
| Mean Weight with Acid | 2.1kg |
| Acid Volume | 0.5l |

Technology

| | |
|------------|-------------------------------|
| Technology | Cast Sb/Sb |
| Separator | Reinforcing fiber+Glass Fiber |



Cell Assembly Layout

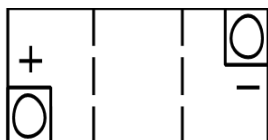

Terminal Type - 6

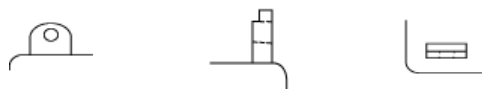

Data Sheet generated on 17/05/2024 - E&OE