



## Yuasa Ficha Técnica

### Yuasa B39-6 - Convencional 6 Volt Batería

#### Rendimiento

Tensión	6
Capacidad (10-hour)	7Ah
Capacidad (20 horas)	7.4Ah

#### Dimensiones (±2mm)

Largo	126mm
Ancho	48mm
Alto	126mm

#### Peso

Peso con Acido	1.7kg
Volumen de acido	0.3l

#### Tecnología

Tecnología	Placa Sb/Sb
Separadores	Reinforcing fiber+Glass Fiber



#### Esquema



#### Tipo de terminal - 6

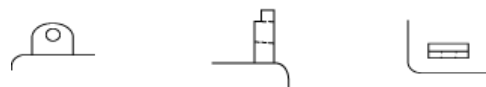

Fecha de emision: 17/05/2024 - E&EO



## Yuasa Technical Data Sheet

### Yuasa B39-6 - Conventional 6 Volt Battery

#### Performance

Voltage	6
Capacity (10-hour)	7Ah
Capacity (20-hour)	7.4Ah

#### Dimensions (±2mm)

Length	126mm
Width	48mm
Height	126mm

#### Weights & Measures

Mean Weight with Acid	1.7kg
Acid Volume	0.3l

#### Technology

Technology	Cast Sb/Sb
Separator	Reinforcing fiber+Glass Fiber



#### Cell Assembly Layout

#### Terminal Type - 6

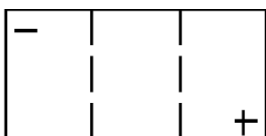

Data Sheet generated on 17/05/2024 - E&OE