



Yuasa Ficha Técnica

Yuasa 12N5.5-4B - Convencional 12 Volt Batería

Rendimiento

Tensión	12
Capacidad (10-hour)	5.5Ah
Capacidad (20 horas)	5.8Ah
CCA @ -18°C	55A

Dimensiones (±2mm)

Largo	137mm
Ancho	61mm
Alto	131mm

Peso

Peso con Acido	2.5kg
Volumen de acido	0.4l

Tecnología

Tecnología	Placa Sb/Sb
Separadores	Reinforcing fiber+Glass Fiber



For Illustration Purposes Only

Esquema

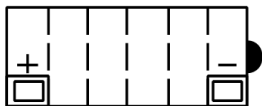

Tipo de terminal - 6

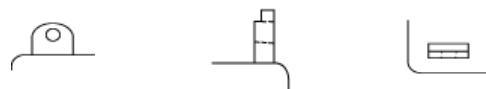

Fecha de emision: 17/05/2024 - E&EO



Yuasa Technical Data Sheet

Yuasa 12N5.5-4B - Conventional 12 Volt Battery

Performance

Voltage	12
Capacity (10-hour)	5.5Ah
Capacity (20-hour)	5.8Ah
CCA @ -18°C	55A

Dimensions (±2mm)

Length	137mm
Width	61mm
Height	131mm

Weights & Measures

Mean Weight with Acid	2.5kg
Acid Volume	0.4l

Technology

Technology	Cast Sb/Sb
Separator	Reinforcing fiber+Glass Fiber



For Illustration Purposes Only

Cell Assembly Layout

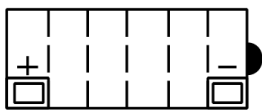

Terminal Type - 6

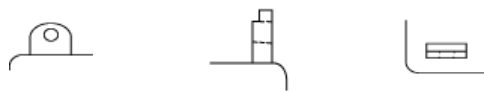

Data Sheet generated on 17/05/2024 - E&OE