



Yuasa Ficha Técnica

Yuasa 12N11-3B - Convencional 12 Volt Batería

Rendimiento

Tensión	12
Capacidad (10-hour)	11Ah
Capacidad (20 horas)	11.6Ah
CCA @ -18°C	109A

Dimensiones (±2mm)

Largo	135mm
Ancho	90mm
Alto	155mm

Peso

Peso con Acido	3.6kg
Volumen de acido	0.8l

Tecnología

Tecnología	Placa Sb/Sb
Separadores	Reinforcing fiber+Glass Fiber



Esquema

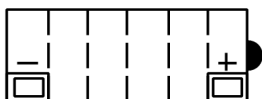

Tipo de terminal - 6

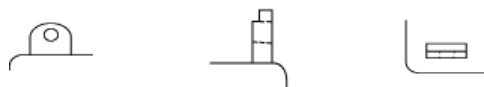

Fecha de emisión: 17/05/2024 - E&EO



Yuasa Technical Data Sheet

Yuasa 12N11-3B - Conventional 12 Volt Battery

Performance

Voltage	12
Capacity (10-hour)	11Ah
Capacity (20-hour)	11.6Ah
CCA @ -18°C	109A

Dimensions (±2mm)

Length	135mm
Width	90mm
Height	155mm

Weights & Measures

Mean Weight with Acid	3.6kg
Acid Volume	0.8l

Technology

Technology	Cast Sb/Sb
Separator	Reinforcing fiber+Glass Fiber



Cell Assembly Layout

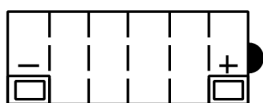

Terminal Type - 6

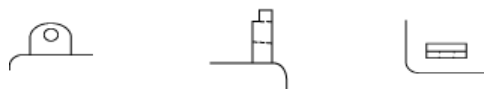

Data Sheet generated on 17/05/2024 - E&OE